

Safety Instructions 



0,1,2,3,4,6,7,8,9,11,15,
20,22,26,27

Info Hotline 

+49 (0) 5041 998 389

Mon. - Do. 7⁰⁰ - 20⁰⁰
Fr. 7⁰⁰ - 17⁰⁰

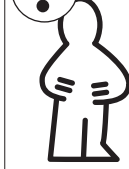

Paulmann Licht GmbH
Quezinger Feld 2
31832 Springe/Germany
www.paulmann.com

Art.-Nr.:

951.36

(+MA 173)

PH 10/13 

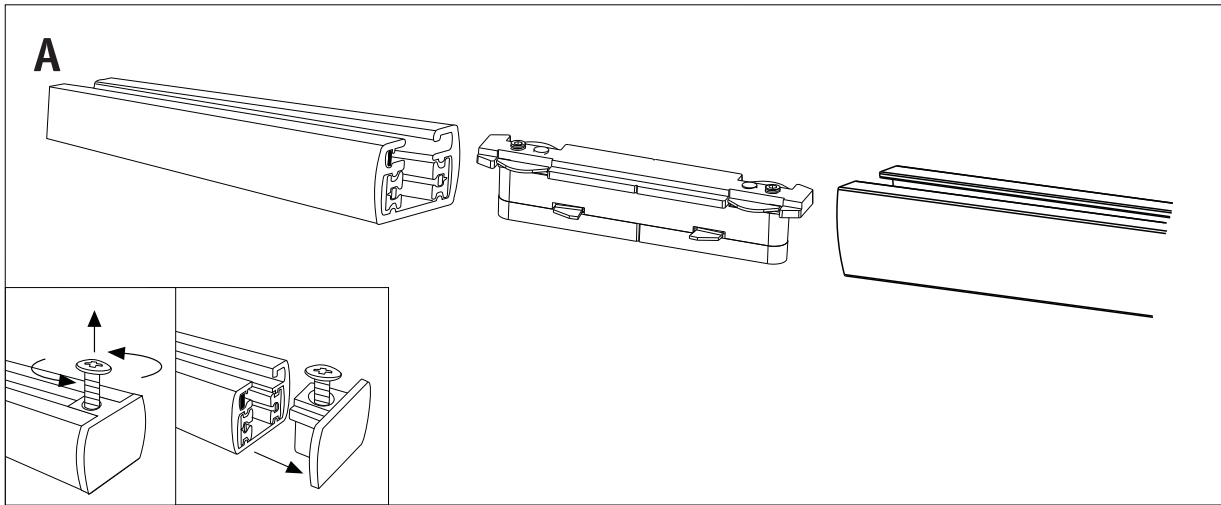
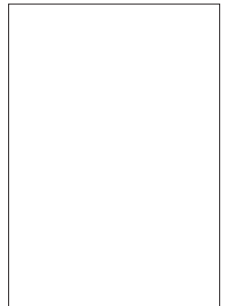
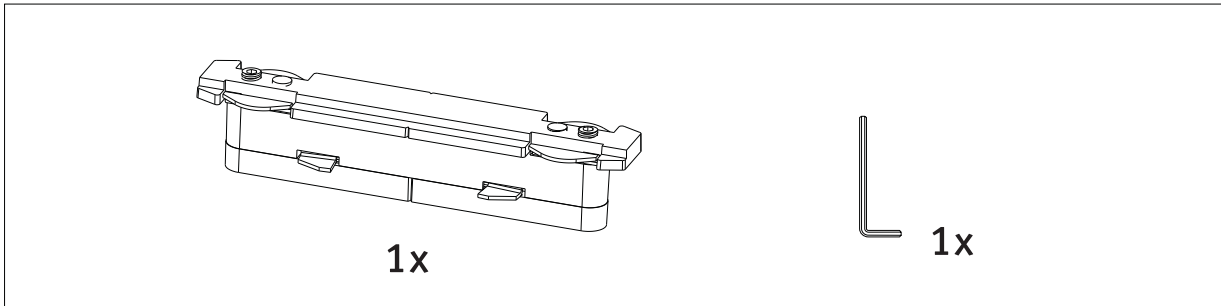

Safety Instructions
Nr. 0,1,2,4

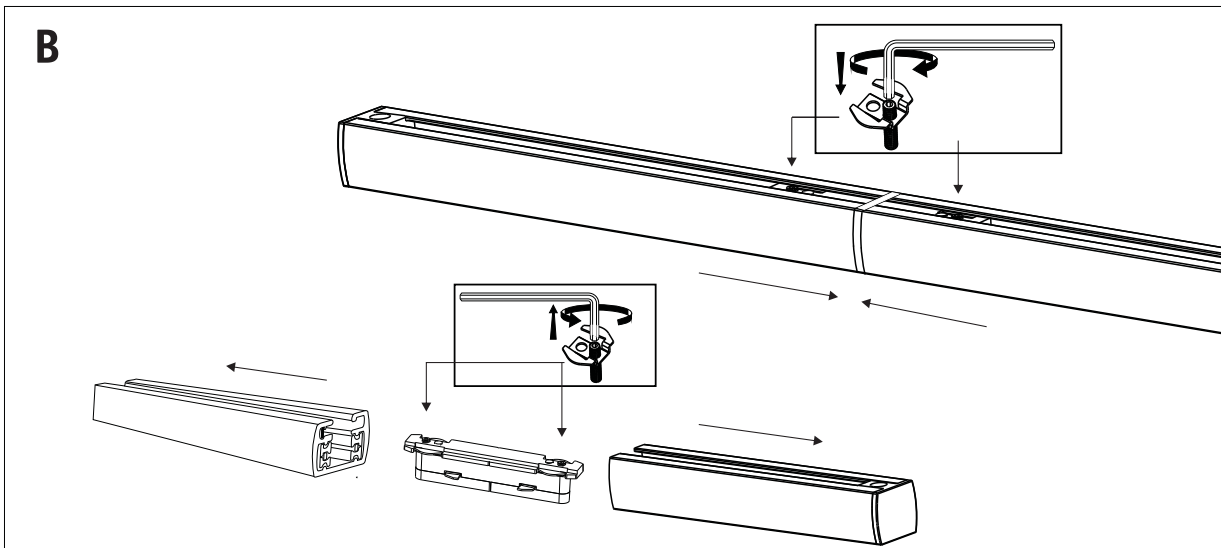

Safety Instructions
Nr. 0,1,2,4

